

GWEN

ARCHITECT

Todd Hallett, AIA, CAPS
TK Design and Associates
info@tkhomedesign.com
www.tkhomedesign.com
248.446.1960

PLAN SIZE

Main level: 3,197 sf
Lower level: 2,250 sf
Six-car garage: 1,425 sf

Luxury does not necessarily equate to size as much as it does to having the ability to design a home that makes you feel like you are permanently on vacation. The luxury home is one that you never want to leave because it is perfectly designed for your needs and wants. The concept of main-level living on one level, and a secondary level dedicated to entertaining and family fun, is a perfect example of luxury. Luxury homes are no longer only designed for the stuffy Grey Poupon crowd; instead, casual smart living is steadily becoming a new form of luxury. Designed to live, and not just to impress, it's the way forward for luxury homes.



- Ⓐ A large great room that is open to the kitchen and dining area is the perfect setup for entertaining and easy living.
- Ⓑ One large dining area replaces the need for a breakfast nook and formal dining. The dining area works in conjunction with the sitting area in the owner's suite to create a private indoor/outdoor space that becomes an extension of everyday living.
- Ⓒ Placing a working den toward the rear of the home provides a view to the lake while allowing immediate access to the core of the home. This is not a fussy showplace library; it is a working space.
- Ⓓ A porte cochère provides cover from the elements and creates a dramatic aesthetic from the exterior.
- Ⓔ A stair that leads to the lower level from the garage is great for bringing large items indoors for storage.
- Ⓕ An additional three-car garage to store goodies like Harleys, a boat, or perhaps the holy grail—a '65 GTO.
- Ⓖ The family entrance helps to keep the family organized with lockers, cubbies, a drop zone, bench, and plenty of storage.
- Ⓗ A simple en-suite bath eliminates the soaking tub and instead provides a two-person shower.
- Ⓘ The secondary bedrooms are not oversized but all have plenty of storage with walk-in closets.
- Ⓙ With all of the primary living on the main level there is no need for an upper level. This plan results in a simple stair configuration that connects the main level with the lower level.

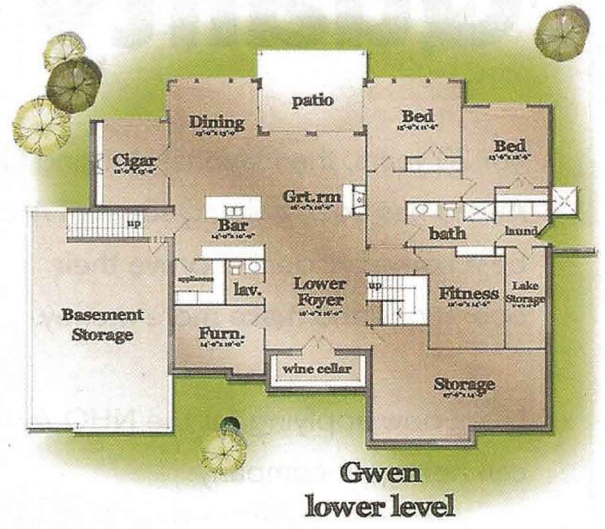

Gwen lower level

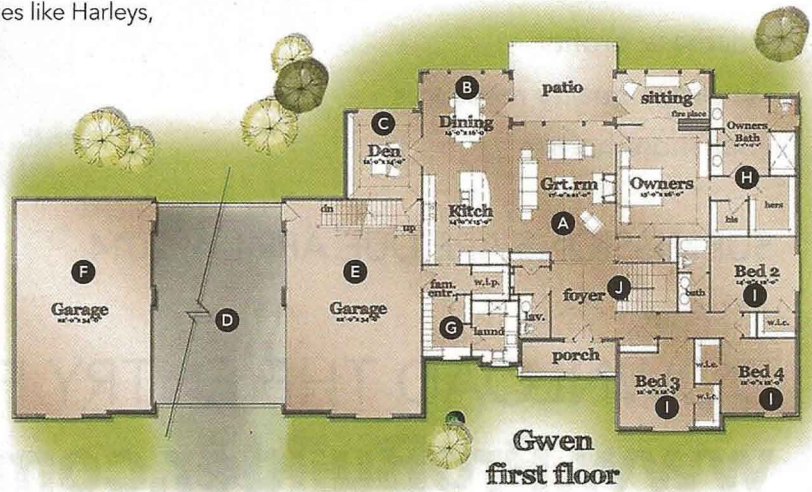

Gwen first floor