

[HOUSE REVIEW]

LAURA

Studies relating to first-time buyers show that their number one concern is value. And maximizing value is the driving principle behind lean design. This

home is a great example of both. Lean design is a collaborative process involving the architect, builder, and trade partners to eliminate waste and optimize marketability by providing buyers with the most bang for their buck. Lean design is not a value engineering exercise designed to strip homes of amenities. Instead it is a process used by leading builders nationwide to create a competitive advantage.

ARCHITECT

Todd Hallett, AIA, CAPS
TK Design and Associates
info@tkhomedesign.com
www.tkhomedesign.com
248.446.1960

PLAN SIZE

Main Level: 1,639 sf
Porches: 43 sf
Width: 40 feet 8 inches
Depth: 54 feet 4 inches
2-Car Garage: 395 sf

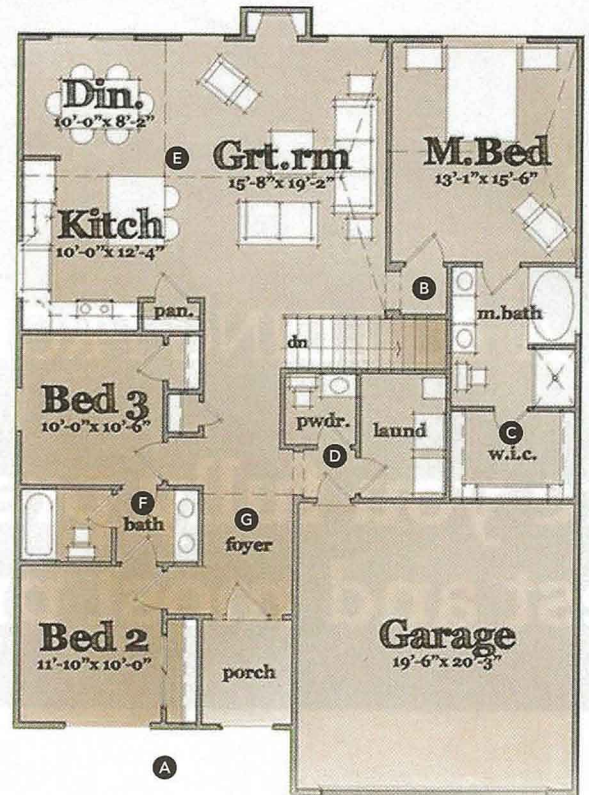

- A** A simple plan form with minimal foundation jogs maximizes ease of construction and buildability while minimizing cost.
- B** An alcove entry to the owner's suite provides privacy from the public spaces.
- C** Placing the owner's closet off the bathroom eliminates unneeded circulation space and optimizes storage.
- D** A powder room is a bit of a luxury in this square footage. This space can also be optioned as a family entrance with a bench and cubbies.
- E** The living triangle is right sized and set up perfectly for day-to-day activities and entertaining.
- F** A Jack-and-Jill bathroom serves the two secondary bedrooms.
- G** The entry foyer provides a long view through the entire depth of the home making the small home seem larger.

